



 gr.	Chiusura aletta / Double bar lock
70	080CA



 gr.	Chiusura triangolo / Triangular lock
70	080CT

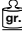

 gr.	Chiusura chiave / Key lock
140	080CC



 gr.	Staffe fissaggio esterno / Wall fixing brackets
110	080SE

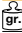

 gr.	Piastra di fondo plastica / Plastic base-plate
1.800	080PP2530
2.700	080PP3040
3.600	080PP4050
4.700	080PP5060



 gr.	Piastra di fondo metallo / Metallic base-plate
2.100	080PM2530
3.200	080PM3040
4.300	080PM4050
5.300	080PM5060

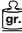

 gr.	Guide regolazione / Adjusting guide
380	080GR200
450	080GR250

PASSACAVI / CABLE CLAMPS[®]

P	$\frac{P}{2}$	F	A	B	C	L	CODICE
PG7	4	12,5	3-6,5	15	8	18-22	010NPG7
PG9	6	15,5	4-8	19	8	22-26	010NPG9
PG11	9	19	5-10	22	8	23-28	010NPG11
PG13,5	11	20,5	6-12	24	10	24-29	010NPG13
PG16	13	22,5	9-14	27	10,5	26-31	010NPG16
PG21	21	29	13-18	33	12	30-35	010NPG21
M12 x 1,5	4	12,5	3-6,5	15	8	21	010NM12
M16 x 1,5	7	16,5	5-10	22	8	23-28	010NM16
M20 x 1,5	11	20,5	6-12	24	10	24-29	010NM20
M25 x 1,5	16	25,5	13-18	33	12	30-35	010NM25

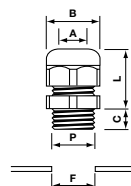

SPIRALI / SPIRALS[®]

P	$\frac{P}{2}$	F	A	B	C	L	CODICE
PG11	16	19	5-10	22	8	80	010FPG11
PG13,5	19	20,5	6-12	24	10	90	010FPG13
PG16	25	22,5	9-14	27	10,5	100	010FPG16
PG21	25	29	13-18	33	11	111	010FPG21
M12 x 1,5	7	126,5	3-6,5	15	8	54	010FM12
M16 x 1,5	10	16,5	5-10	22	8	80	010FM16
M20 x 1,5	19	20,5	6-12	24	10	90	010FM20
M25 x 1,5	33	25,5	13-18	33	12	112	010FM25

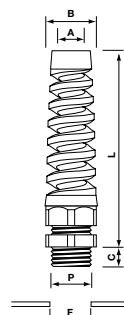

CONTRODADI / LOCK NUT[®]

P	$\frac{P}{2}$	B	H	CODICE
PG7	1	19	5	010DPG7
PG9	2	22	5	010DPG9
PG11	2	24	5	010DPG11
PG13,5	2,5	27	6	010DPG13
PG16	3	30	6	010DPG16
PG21	3,5	36	7	010DPG21
M12 x 1,5	1	18	5	010DM12
M16 x 1,5	1,5	24	6	010DM16
M20 x 1,5	2	27	6	010DM20
M25 x 1,5	3	34	7	010DM25

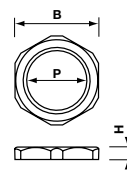

TAPPI / PLUGS[®]

P	$\frac{P}{2}$	ϕ A	H	CODICE
PG7	1	15	6	010TPG7
PG9	1,5	19	6	010TPG9
PG11	2	22	7	010TPG11
PG13,5	2	25	7	010TPG13
PG16	3	27	7	010TPG16
PG21	5	33	9	010TPG21
M12 x 1,5	1	15	6	010TM12
M16 x 1,5	2	22	6	010TM16
M20 x 1,5	2,4	24	7	010TM20
M25 x 1,5	4	33	9	010TM25

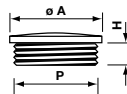

040/080

(1) Poliammide PA6 autoestinguente cl. V2 (UL94) - Temperatura d'impiego $-20^{\circ} \pm +90^{\circ}$ / V2 (UL94) self-extinguishinPA polyamide operating temperature $-20^{\circ} \pm +90^{\circ}$

(2) Polistirolo PS - Temperatura d'impiego $-20^{\circ} \pm +60^{\circ}$ / PS Polystirene - operating temperature $-20^{\circ} \pm +60^{\circ}$

Raccordi metallici / Metal connectors⁽¹⁾

Raccordo curvo a 45° - Connector bent to 45°



gr.	D	XOK		L	
26	M16x1,5	11,5	19	10	010GIM16
38	M20x1,5	15	23	10	010GIM20
55	M25x1,5	20	28	10	010GIM25
90	M32x1,5	27	36	10	010GIM32

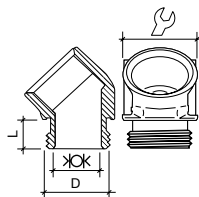

Pressacavi / Glands



gr.	D	XOK		LF	
14	M16x1,5	5 ÷ 9	18	17	010POM16
20	M20x1,5	8 ÷ 12	22	22	010POM20
34	M25x1,5	11 ÷ 16	28	28	010POM25
50	M32x1,5	15 ÷ 21	35	35	010POM32

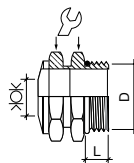

Ghiera ribassate / Flat rings nuts



gr.	D		S	
4	M16x1,5	19	3	010GM16
6	M20x1,5	24	3,5	010GM20
12	M25x1,5	30	3,5	010GM25
26	M32x1,5	36	4,5	010GM32

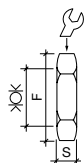

Nippli / Nipples



gr.	D	XOK	L	
8	M16x1,5	12	21	010NPM16
20	M20x1,5	15	24,5	010NPM20
18	M25x1,5	20	25	010NPM25
30	M32x1,5	26	32	010NPM32

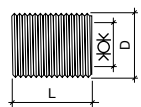

Bussole / Adaptors



gr.	D	XOK		L	
18	M16x1,5	M13x1,5	22	12	010BM16
22	M20x1,5	M15x1,5	26	14	010BM20
20	M25x1,5	M21x1,5	30	14	010BM25
28	M32x1,5	M28x1,5	40	15	010BM32

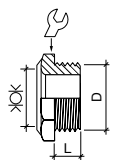

Valvola di ventilazione anticondensa *Anti-condensate ventilation valve*



La valvola anticondensa è la soluzione ideale per risolvere i problemi di compensazione di pressione e protezione dall'umidità che si possono creare nelle cassette pulsantiere poste in condizioni ambientali critiche. La particolare struttura a membrana permette la circolazione dell'aria ed impedisce l'entrata di liquidi all'interno della cassetta grazie anche alla guarnizione O-ring.

La valvola trova applicazioni ottimali in pannelli di controllo, telai di motori, cassette, pompe, luci sotterranee, luci spot, ecc.

The anti-condensate valve is the ideal solution to solve pressure compensation and humidity problems that could arise with push-button panels, enclosed in boxes and exposed to critical environmental conditions. Its special membrane configuration, along with the O-ring with which it is equipped, facilitate the circulation of air and prevent the entrance of liquids inside the box. This valve can be ideally used for control panels, motor frames, boxes, pumps, underground lighting systems, spot lights, etc.



Caratteristiche - Characteristics

Permeabile all'aria e resistente all'acqua in entrambe le direzioni.
Permeable to air and resistant on both sides.

Repellente all'olio: 010VV - 010VV400
Oleophobic: 010VV - 010VV400

Superficie attiva delle membrane nel tappo di aerazione è di 0,5 cm²
Activated area of the membrane in the aeration cup is 0,5 cm²

Grado di protezione: IP67
Protection degree: IP67

Temperatura di lavoro: -40°C / + 105°C
Operating temperature: -40°C / +105°C

L'applicazione orizzontale non è consigliata
Horizontal application is not recommended

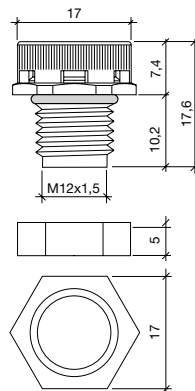

040/080



permeabilità all'aria
permeability to air

pressione ingresso acqua
water inlet pressure



1,5		0,9lt./min. $\Delta p = 1$ bar	> 1,5 bar	010VV
1,5		0,4lt./min. $\Delta p = 70$ mbar	> 0,6 bar / 60s	010VV400
1,5		1,7lt./min. $\Delta p = 70$ mbar	> 0,3 bar / 60s	010VV1700
0,7				010DM12